

Is it safe to install photovoltaic panels in cold storage

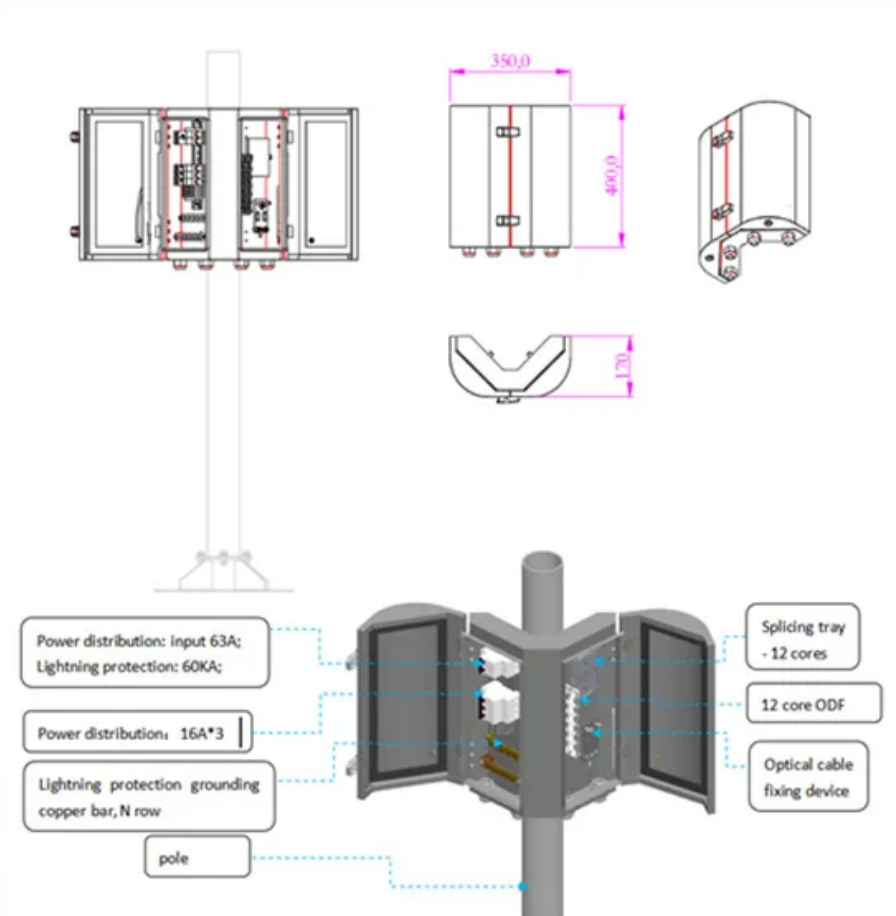

Overview

Let's cut through the snowflakes – installing photovoltaic panels in winter isn't inherently dangerous, but it does require extra precautions. Cold weather can significantly impact the efficiency and performance of solar energy systems; however, techniques exist to safeguard solar energy production.

Implementing strategies such as (1) regular maintenance and inspection, (2) proper panel positioning and tilt adjustments, (3) utilizing. We don't really want to have the solar equipment in the house, especially batteries as it's a rather small space and everything is going to take quite a bit of room. Could we build a small shed for the components and batteries?

I am not sure if we are going with lithium or lead acid batteries yet. Actually, solar technology can be leveraged in virtually any condition, including rainy and snowy days, because some sunlight still reaches the earth. When the heat is extreme, this may even cause them to fail and shut down entirely. In fact, cold climates are actually the optimal environment for solar.

Is it safe to install photovoltaic panels in cold storage

Commercial and Industrial ESS

Air Cooling / Liquid Cooling

- Budget Friendly Solution
- Renewable Energy Integration
- Modular Design for Flexible Expansion



[Snow on Solar Panels: What You Need To Do - Forbes Home](#)

Because heat can actually cause the photovoltaic cells that make up the panels to perform suboptimally, colder temperatures (especially colder temperatures without snowfall) are ideal for

[Do Solar Panels Work In The Winter And Cold Weather?](#)

Wonder whether solar panels work in the snow? Solar panels don't just work under direct sunlight. Learn the science behind them and find out how you can optimize their use even during the ...



[Solar Panel Safety tips for winter: Essential Tips](#)

This article provides a detailed guide on keeping your solar panels safe during the cold months. It includes important tips and methods to protect your investment and get the most energy.

[Is It Safe to Install Solar Panels in Winter? A Practical Guide](#)

Let's cut through the snowflakes - installing photovoltaic panels in winter isn't inherently dangerous, but it does require extra precautions. Imagine trying to build a snowman during a blizzard versus on a ...



[How to protect solar energy when the weather is too cold](#)

Incorporating battery storage for solar energy systems during winter months ensures greater energy reliability. A significant benefit of storage solutions is the ability to retain surplus ...



[Busted: Common Solar Myths and Misconceptions](#)

Solar panels tend to perform best in cold and sunny climates because heat interferes with the conversion of sunlight into electricity. (Keep in mind that solar panels collect light, not heat.) On ...

◆ **PRODUCT INFORMATION** ◆

- BATTERY CAPACITY
50kWh-500kWh
- DC VOLTAGE RANGE
400V-1000V
- DEGREE OF PROTECTION
IP54
- OPERATING TEMPERATURE RANGE
-10-50°C



[Where to Store Solar Components and Batteries in Cold Climates](#)

A Cool Roof System with a thermally broken roof that uses convection to vent warmed air out during summer & preventing cold transfer through the roof can save you over 50% of your ...

[Debunking Solar Battery Storage Myths in Cold Climates](#)

Whether you're worried about your investment's longevity or concerned that the Pacific Northwest climate might undermine storage performance, this deep dive will show you how solar ...



[Winter Home Solar Storage System Guide: Ensuring Energy Stability](#)

A home solar storage system typically consists of solar panels, inverters, and storage batteries. While inverters and batteries are usually installed indoors, solar panels face harsh winter conditions.

[Keeping Solar Batteries Outside \(The Dos and ...](#)

Lithium-ion batteries, which are commonly used in solar ...



[Keeping Solar Batteries Outside \(The Dos and Don'ts\)](#)

Lithium-ion batteries, which are commonly used in solar energy storage systems, are generally better suited for indoor installation. They have a narrower temperature operating range ...

Contact Us

For catalog requests, pricing, or partnerships, please visit:
<https://www.motocykle3city.pl>